

GENERAL FUNCTION:

The Hydro-Force Revolution injection sprayer is used to quickly, and evenly apply pre-spray, protector and other chemicals over large areas. The Hydro-Force Revolution injection sprayer is unique because you can adjust dilution ratios on the fly by simply turning a knob. The Hydro-Force Revolution injection sprayer can be used at pressures as low as 50 PSI or as high as 1,000 PSI. All Hydro-Force Revolution sprayers are set at the factory to be used at water pressures of 400 P.S.I. but can easily be configured to work at lower pressures by simply changing the knob to a low pressure knob (1640-2822). See 'Low Pressure Instructions' below. Water flow is automatically reduced as it passes through the injector valve, thus reducing the pressure approximately 64%. To obtain the actual working pressure of your Hydro-Force Revolution injection sprayer, multiply your incoming pressure by 36%.

PRE-SPRAY AND TRAFFIC LANE APPLICATIONS:

Hydro-Force injection sprayers eliminate the hassles of measuring and mixing. We recommend you keep an extra 5-quart container or two on your truck to make sure you never run out and to facilitate quick changes of your chemical containers. Remember that Hydro-Force sprayers automatically mix at a 1 to 8 ratio. If your 5-quart container is full then that is the same as holding an 11 gallon pump sprayer of regular, ready to use pre-spray.

Hydro-Force injection sprayers offer better penetration and overall coverage than other sprayers. It is therefore possible to pre-spray your jobs up to 45 minutes before that area needs to be cleaned. An effective way to use the Hydro-Force sprayer for pre-conditioning is to start at the door coming into the house; spraying all the traffic areas and work your way to the farthest point back in your job. You have then completed your pre-conditioning in just seconds and are prepared to hook up your wand and start cleaning your way out.

On larger jobs, or jobs involving more than an hour of cleaning time, it is recommended that you pre-spray an area that will take no longer than 45 minutes to clean. You can then hook up your Hydro-Force again and pre-spray another large area.

APPLICATION OF CARPET PROTECTORS:

This highly profitable procedure is often passed up on many jobs because it is too big of a 'hassle'. Operators will not mention the availability of protectors because they are running short on time and must hurry to their next job, or they don't want to take the time to rinse tanks then measure, mix and pump.

Hydro-Force injection sprayers bypass these hassles and encourage you to apply carpet protectors. Go

to your machine, shut off the chemical and, if you prefer, your heat. You should then take a 5 quart container with clean water (adding an ounce or two of acid or vinegar will help) to your Hydro-Force injection sprayer unit. Take off your traffic lane bottle and put on clean water. Run your Hydro-Force injection sprayer for approximately 20 seconds or until all soap is out of your lines. You may then put on your 5 quart container with carpet protector in it. Your product should be concentrated and diluted at 1 to 8 for application on damp carpet. If this is a difficult dilution to reach you may remove the metering tip to obtain a 1 to 4 ratio. If you are using Scotchgard® or a Teflon® product on dry carpet you should dilute them 1 to 1 with water before you use them with a Hydro-Force injection sprayer. Whether you use Maxim™ or another product, you will find that a 5 qt. container will go a long way. 5 qts. diluted 1 to 8, gives you 11 gallons of ready to apply protector. With a coverage rate of 300 square. ft. per gallon, 5 qts. of protector will cover 3,000 square ft.

Keep in mind that your Hydro-Force injection sprayer is spraying 3 to 4 times the amount of product your normal pump sprayer is putting out. This means you must move quickly to avoid over-applying. Protector should be applied in even, slightly overlapping strokes. You should proceed from the entrance again working your way toward the farthest point.

LOW PRESSURE INSTRUCTIONS

Your solution hose pressure affects how much chemical is drawn from the Hydro-Force injection sprayer. Higher pressures decrease the ratio of chemical to water and lower pressures increase the ratio of chemical to water. If you are using pressures ranging from 50 to 200 PSI, you'll want to install the low pressure knob (1640-2822) so your dilution ratios are more properly calibrated. We recommend using 100 PSI when using the low-pressure knob for the most accurate dilution ratios.

HYDRO-FORCE™ REVOLUTION®

Injection Sprayer



Part Number: A99934

PID: 99934

Patent Number: 6,182,911 B1

For those that want to Revolutionize how their spraying is done, the Revolution takes efficiency to a new level by allowing cleaners to dial in the exact concentration of chemical needed. Cut your spray time in half! Quickly apply presprays, deodorizers, tile and grout cleaning solutions, sanitizers, protectors and more.

To learn how you can save time
and money using a Hydro-Force sprayer
call 800-637-3789 or visit www.aramsco.com

 **HYDRO-FORCE™**
Innovating since 1974

PARTS BREAKDOWN

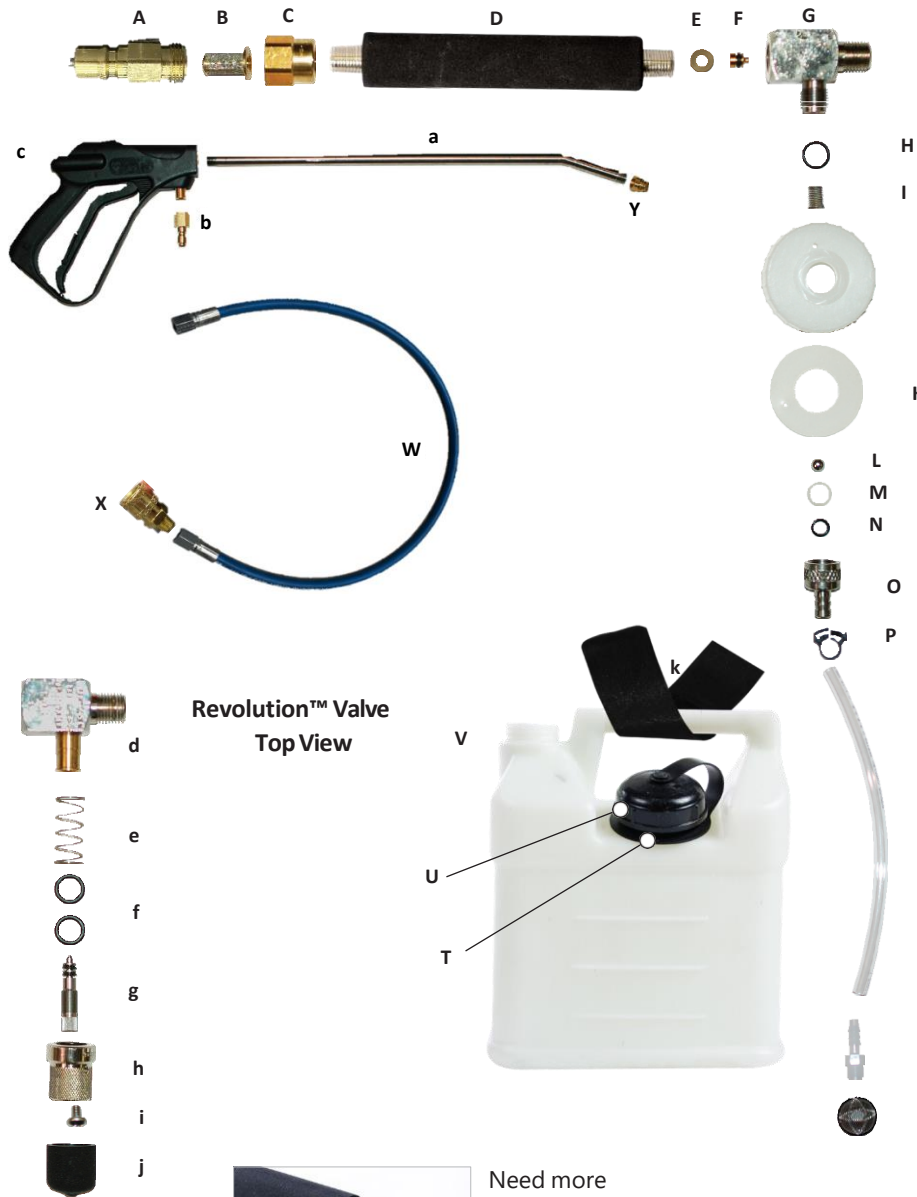

Revolution™ Valve
Top View



Need more juice? Instantly change the dilution ratio to blast away greasy stains.

PARTS LIST

	PART DESCRIPTION	PART #	PID
A	1/4" Male QD To Strainer	2680-6784	268870
B	Strainer	1679-0875	107789
C	Strainer Adapter	1671-0079	107701
D	Insulated Handle	2695-0877	207985
E	Backup Washer	1601-0884	108081
F	Water Nozzle with O-Ring	1664-4635	143664
G	Injector Valve Complete	1649-2720	122479
H	Viton O-Ring	1606-2325	122036
I	Check Valve Spring	1647-2728	122477
J	Formed Bottle Cap	1685-0378	107835
K	Cap Liner	1676-2128	122716
L	Steel Ball	1632-3267	136322
M	Spacer	1698-2201	120928
N	Viton O-Ring	1605-2324	122035
O	Suction Nut	1653-0180	108513
P	Clamp HF Draw Tube	1631-2922	122391
Q	Tubing	2666-0112	201616
R	1/4" x 1/8" Hose Barb	1629-1510	111259
S	Acorn Strainer	1604-0786	108074

	PART DESCRIPTION	PART #	PID
T	Retainer Side Cap	1670-2627	122760
U	Cap Sideport	1655-2815	121582
V	5 Quart Container	1691-2584	128951
W	Hose Assembly	2687-2681	228867
X	1/4" Female Flow Thru	1630-0891	109380
Y	Veejet Brass 1/4" Female	1630-0898	109984
a	18" Extension	1667-0895	109687
b	1/4" Male Flow Thru	1629-0583	108259
c	Spray Gun	1658-0678	107568
d	Valve Body	1649-2720	122479
e	Meter Stem Spring	1636-3162	136326
f	Viton O-Ring	1609-2328	122039
g	Stem Assembly	1668-4639	143668
h	Metering Knob – HP	1640-2822	122480
i	Pan Screw	1699-2202	120929
j	Knob Cover	1648-2729	122478
k	Velcro Strap	1691-2483	128941

TROUBLE SHOOTING GUIDE

PROBLEM: Will Not Draw Chemical			
CAUSES	PART #	PID	SOLUTIONS
Inlet Strainer Clogged	1679-0875	107789	Clean or Replace
Wrong Teejet Size	1694-0898	109984	Replace
Acorn Strainer Clogged	1604-0786	108074	Clean or Replace
Metering Tip Clogged	1662-0799	109672	Clean or Replace
Water Nozzle Clogged or Worn	1664-4635	143664	Clean or Replace
Injector Valve Needs Major Rebuild	1621-2817	121281	Install Kit
Bad Injector Valve	1639-1029	112309	Replace
Chemical Build-up Inside of Valve	1639-1029	112309	Clean w/ Vinegar
PROBLEM: Container Backfills			
Injector Valve Needs Rebuild	1633-0173	107313	Install Backflow Kit
Bad Injector Valve	1639-1029	112309	Replace
PROBLEM: Does Not Shut Off or Leaks From Gun			
Worn Gun	1658-0768	107568	Replace
Valve Needs Rebuild	1649-0878	107489	Replace
Worn Valve in Gun	1670-2211	121720	Replace