

Dual Input Hygro-Thermometer Psychrometer

Model RH350

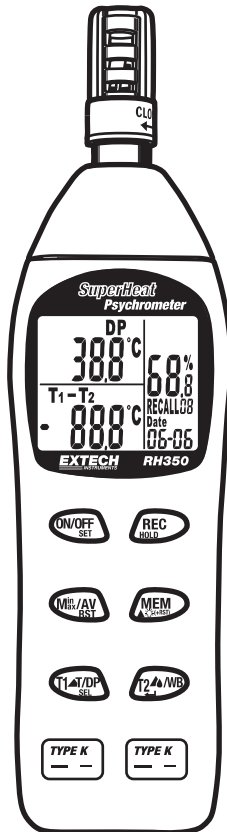

Introduction

Thank you for selecting the Extech Model RH350. This device is shipped fully tested and calibrated and, with proper use, will provide years of reliable service. Please visit the Extech Instruments website (www.extech.com) to check for the latest version of this User Guide.

Meter Description

1. Humidity Sensor & Air Temperature Sensor
2. Triple LCD Display
3. On/Off; Set Mode
4. Min/Max/Average; Reset Min/Max
5. Air, T1, Air-T1, Dew Point
6. T1 probe input
7. T2 probe input
8. T1-T2, T2, T1-Dew Point, Wet Bulb
9. Store Current Reading; Backlight
10. Hold; Recall Mode
11. RS232 port

Note: The battery compartment is located on the rear of the instrument

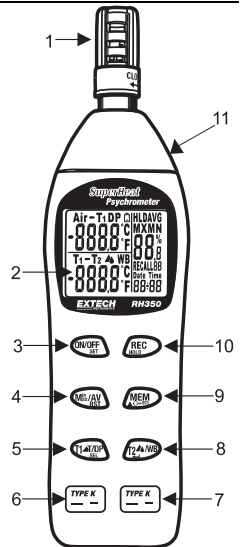

Display Description

1. Air, T1, Air-T1, Dew Point, Low Battery
2. Temperature °C/°F
3. T2, T1-T2, T1-Dew Point, Wet Bulb
4. Temperature °C/°F
5. Date (month, day, year), Time (24 hour clock)
6. Memory Store/Recall Location
7. Relative Humidity %
8. Maximum, Minimum
9. Hold, Average

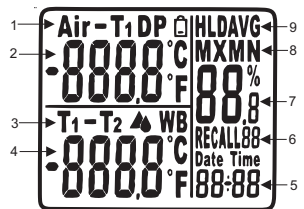

Operation

Open the Protective Sensor Cap

Twist the protective sensor cap, located at the top of the meter, counter-clockwise a quarter of a turn to expose the sensors.

Turn Power ON or OFF

Press the **[ON/OFF]** button to turn power on or off. The meter will perform a short self-test when turned on.

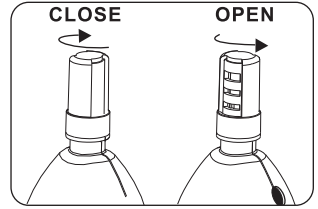

Taking measurements

1. Hold the probe in the area to be tested.
2. Allow adequate time for readings to stabilize.
3. The Relative Humidity measurement appears in the right display along with the date and time.
4. Air Temperature appears in the top left display.
5. Wet Bulb is in the lower left display.
6. Pressing the **[T1T/DPSEL]** button toggles the top left display between Air temperature, T1 temperature, Air-T1, and DP (Dew Point).
7. Pressing the **[T2▲WB]** button toggles the lower left display between WB (Wet Bulb), T1-T2, T2, and T1-DP (Dew Point).

SETUP

When the meter is off, press and hold the **[ON/OFFSET]** button for more than 2 seconds to enter setup mode. Prnt will appear on the display.

1. Selecting temperature units of measure (C/F)

Momentarily press the **[T1T/DPSEL]** button until "unit" appears in the display.

Press the **[MEM]** button to toggle between C or F.

Press the **[T2▲WB]** button to confirm the setting and return to normal operation.

2. Setting the Date/Time (24 hour clock)

Press the **[T1T/DPSEL]** button to select Year, Month, Day, Hour and Minute in sequence.

Press the **[MEM]** button to change the settings.

Press the **[T2▲WB]** button to confirm the date/time setting and return to normal operation.

Data Hold

Press the **[RECHOLD]** button momentarily to freeze the displayed reading. The 'HLD' icon will appear on the upper right-hand side of the display. Press the **[RECHOLD]** button again to return to normal operation.

Minimum (MN) Maximum (MX) Average (AVG) Function

The MIN/MAX/Average mode allows the user to view only the lowest (**MN**), highest (**MX**) or average readings. Press the **[Mⁿ/AVRST]** button once and **MN** appears on the display. The display is now showing the lowest humidity and temperature readings in memory. Press the **[Mⁿ/AVRST]** button again and **MX** appears on the display. The display is now showing the maximum humidity and temperature readings in memory. Press the **[Mⁿ/AVRST]** button again to display the average (**AVG**) readings in memory. To exit the MIN/MAX/AVG mode, press the **[Mⁿ/AVRST]** button. To clear the current min/max/avg readings in memory, press and hold the **[Mⁿ/AVRST]** button for more than two seconds.

Backlight Display

Press the **[Mⁱⁿ/AVRST]** and **[MEM]** buttons together to turn on the backlight. It will remain on for ten seconds.

Automatic Power OFF

With the meter off, press and hold down the **[ON/OFFSET] + [RECHOLD]** buttons for more than 1 second to enter auto power off settings.

Press the **[MEM]** button to select non-sleep (n) or 2, 5, 10, 20, 40 and 60 minutes autosleep.

Press **[T2 ▲ WB]** to confirm the selection.

Manual Datalogging

Manual datalogging allows the user to store and recall up to 99 readings with the press of a button.

1. Press the **[MEM]** button to manually store a single reading into memory. The display will flash 3 times and the memory location number will be displayed below the humidity reading.
2. To view stored readings, press and hold the **[RECHOLD]** button for 2 seconds and "RECALL" will blink next to the memory location number on the display.
3. Press the **[MEM]** button to manually increment through the stored readings.
4. Press **[RECHOLD] + [MEM]** for more than 1 second to clear the memory.
5. Press **[RECHOLD]** for more than 1 second to return to normal operation.

Note: In RECALL mode, pressing the **[Mⁱⁿ/AVRST]** button for min/max/avg readings will auto search the stored readings in memory and display the minimum, maximum and average values of the stored readings.

Note: A printer port is located on the side of the meter; however it is not functional on this model.

Calibration

The following verification and calibration procedures require the 33% and 75% RH reference bottles which are supplied with the Model RH350-CAL kit.

Accuracy Verification

Checking the 33% or 75% RH Calibration

1. Insert meter's sensor into the 33% or 75% salt reference bottle
2. Check the reading after a minimum of 10 minutes
3. Verify that the reading is within the accuracy specification

Relative Humidity Calibration (33% and 75%)

33% Calibration

1. Turn the meter Off.
2. Insert the meter sensor into the 33% salt reference bottle.
3. Allow the meter one hour to stabilize.
4. While holding down the **[Mⁱⁿ/AVRST]** button, press and hold the **[ON/OFFSET]** button for 2 seconds to enter calibration mode.
5. "32.8%" (reading may vary depending on operating temperature) will flash on the LCD screen. After 30 minutes, the flashing will stop to indicate that the 33% calibration is complete.

Note: Do NOT turn off the meter

6. Proceed to the 75% Calibration below.

75% Calibration

1. Insert the meter sensor into the 75% salt reference bottle.
2. Allow the meter one hour to stabilize
3. Press and hold the **[Mⁿ/AVrst]** button for 2 seconds to enter the 75% calibration.
4. "75.3%" (reading may vary depending on operating temperature) will flash on the LCD. After 30 minutes, the flashing will stop to indicate that the 75% calibration is complete.
5. Calibration is now complete. Turn power off.

Note: Frequently check the water level in the salt bottles. Both the 33% and 75% bottles should be completely saturated with some water present. The bottles are sealed and not refillable.

RS-232 PC Communications Interface

The meter is equipped with an RS-232 PC interface jack (3.5mm phono) for connection to a PC. The cable to connect the meter to the PC is included in the optional 407752 data acquisition kit. The kit includes Windows™ compatible software that allows the user to store readings in a text file and display real-time measurements in a series of selectable formats. For more information or specific operating instructions, refer to the User Guide included with the 407752 kit or contact Exttech.

Specifications

Function	Range and Resolution	Accuracy
Humidity	0.0 to 100.0% RH	±3% RH (10 to 90%) @ 23°C
Temperature (air)	-20 to 50°C (-4.0 to 122.0°F)	±1°C (±1.8°F)
Temperature (external K)	-200 to 1370°C (-328 to 2498°F)	±(0.3% rdg + 1°C (1.8°F))

Display	Triple LCD
Sensor Type	Humidity: Precision capacitance sensor Internal Temperature: Thermistor External Temperature: K-Type Thermocouple
Response Time	60 seconds typical
Dew Point	-68 to 50°C (-90.4 to 122.0°F) (calculated from RH and Air temperature measurements)
Wet Bulb	-21.6 to 50°C (-6.88 to 122.0°F) (calculated from RH and Air temperature measurements)
Low Battery Indicator	Yes
Overrange Indicator	E2 (air) E5 (T1), E8 (T2)
Underrange Indicator	E3 (air), E6 (T1), E9 (T2)
Operating Conditions	-20 to 50°C (-4 to 122°F); < 99% RH non-condensing
Storage Conditions	-40 to 85°C (-40 to 185°F); < 99% RH non-condensing
Power Supply	4 x 1.5V 'AAA' batteries
Battery Life	Approx. 300 hours
Dimensions / Weight	230 x 57 x 44mm (9 x 2.2 x 1.7"); 153g (5.3 oz.)

Maintenance

Cleaning and storage

1. The meter should be cleaned with a damp cloth and mild detergent when necessary. Do not use solvents or abrasives.
2. Store the meter in an area with moderate temperature and humidity (refer to the operating and storage range in the specifications chart earlier in this manual).

Battery Replacement

When the battery power falls low, the  symbol will appear on the LCD. Replace the four (4) 1.5 'AAA' batteries by removing the rear battery compartment cover and accessing the battery compartment. Observe polarity when placing the batteries in the compartment. Ensure that the compartment cover is securely fastened when finished.



Never dispose of used batteries or rechargeable batteries in household waste. As consumers, users are legally required to take used batteries to appropriate collection sites, the retail store where the batteries were purchased, or wherever batteries are sold.

Disposal: Do not dispose of this instrument in household waste. The user is obligated to take end-of-life devices to a designated collection point for the disposal of electrical and electronic equipment.

Other Battery Safety Reminders

- Never dispose of batteries in a fire. Batteries may explode or leak.
- Never mix battery types. Always install new batteries of the same type.

Copyright © 2014 FLIR Systems, Inc.

All rights reserved including the right of reproduction in whole or in part in any form

www.extech.com