

FLASH XTRACTOR II

NEXT GENERATION

SUB-SURFACE FLOOD EXTRACTION TOOL

AC002



Water Claw
4282 South 590 West
Salt Lake City, UT
84123
801-268-2673
801-268-3856 FAX

INTRODUCTION

Congratulations on your purchase of the Flash Xtractor II. The Flash Xtractor II is designed to give superior water removal performance when used with portable or truck mounted extractors. Years of experience, engineering, and planning have gone into the design and manufacturing of the Flash Xtractor II. We take a great deal of pride in the Flash Xtractor II; our goal is no less than your complete satisfaction.

Extraction is the most efficient method of removing water in structural flooding situations.

The subsurface extractors are designed for water removal on carpet and pad, without removing the pad. On glue down carpet installed without pad, the Flash Xtractor II is less productive.

The superior water removal achieved using the Flash Extractor II will make your other drying methods more affective and speed the drying process.

This manual will provide users with the knowledge to operate and maintain the Flash Xtractor II to ensure maximum water removal.

Any questions pertaining to the operating or servicing of this unit should be directed to your nearest Water Claw distributor.

This manual is written specifically for the Flash Xtractor II tool manufactured by:

Water Claw
4282 South 590 West
Salt Lake City, UT 84123
801-268-2673
801-268-3856 FAX

Information in this manual is subject to change without notice and does not represent a commitment on the part of Water Claw, its parent or affiliated companies.

SPECIFICATIONS

Model AC002 Flash Xtractor II:

Base Dimensions:

Handle Height: 24.5" to 38.5"

Weight: 6.5 lbs.

Base Construction: 20% Glass Filled Polypropylene (Black)

Vacuum Elbow Construction: Polycarbonate – (Clear)

Handle Base / Foot Bracket: 20% Glass Filled Polypropylene (Black)

Handle Construction: Aluminum

ASSEMBLING THE FLASH XTRACTOR II

1. Place the T-Handle into the Handle Base / Foot Bracket and align the Spring Button with the hole in the base so the button snaps into the hole.
2. Pull the lever on the Cam Lock Clamp out away from the handle tube to loosen the clamp. Pull the handle up to adjust the handle height for comfortable operation.
3. Push the lever on the Cam Lock Clamp down to tighten the clamp and secure the handle at the desired height. If the clamp is too loose, the clamp tension can be increased. Pull the lever out and then tighten the Tension Nut on the Cam Lock Clamp to increase the tension level as needed and then push the lever back down to secure the handle.

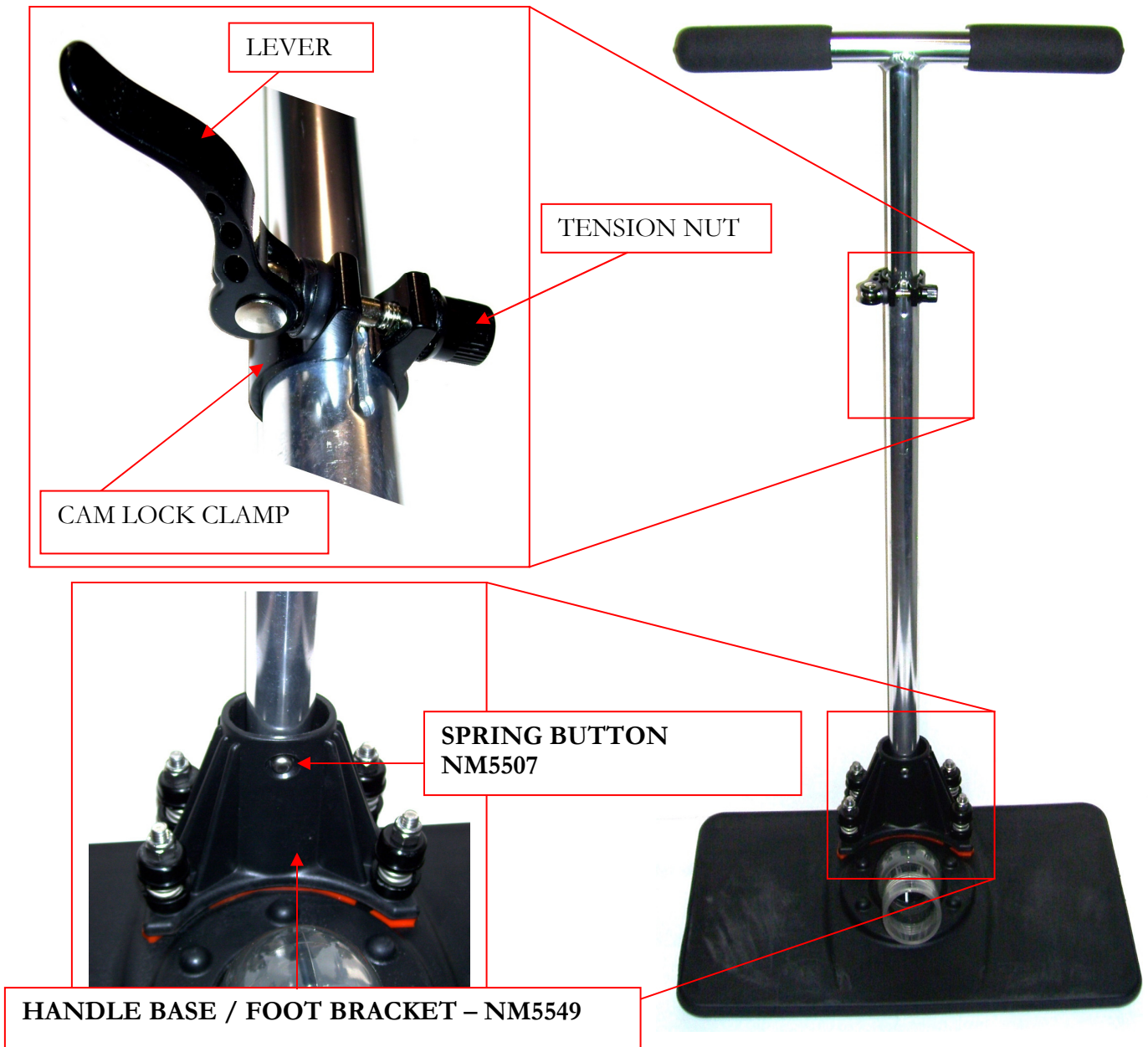

USING THE FLASH XTRACTOR II

Extraction Equipment

The Flash Xtractor II will work with portable or truck mounted extractors.

The higher air flow of truck mounted extractors will allow your Flash Xtractor II to extract more water, faster. When using a portable extractor, if you slow down to allow the tool to extract more water you will still get excellent results.

Extraction Procedure

1. Connect the vacuum hose from your extractor to the elbow barb on the top of the Flash Xtractor II base. A 2" cuff will fit over the barb, a 1-1/2" cuff will fit inside the barb.
2. Turn the extractor ON.
3. If there is standing water, place the Flash Xtractor II in the center of the room to remove the standing water down to the carpet level. When the standing water has been removed, place the Flash Extractor in the desired starting point, usually in a corner of the room, and stand on top of the Flash Xtractor II. After approximately 5-10 seconds, the majority of the water will be removed. Continued extraction from 10 - 30 seconds may remove more water, however by 30 seconds any additional extraction time produces little or no increase in removal. The exact time between position changes can be determined by watching the flow rate of the water being extracted and moving when the flow diminishes. When ready to move, pull the handle back to release the vacuum as you step off of the Flash Xtractor II and move to the next position. The movement to the next extraction position can be to the side, forward or back. The new position should be adjacent to but not overlapping the previous extraction position. Repeat the movement and extraction procedure until you have covered the entire area to be extracted.
4. After you have completed your extraction pass over the entire area, disengage a portion of the carpet in the area being extracted and test the pad to determine if additional extraction is required. Squeeze the pad. If you can squeeze out any water, you need to make another pass over the area with your Flash Xtractor II. Repeat test and extract more as needed. When in doubt, extract again.
5. A standard carpet wand can be used with your extractor to remove any residual water remaining on the carpet face fibers.

Extracting the water from the carpet & pad using your Flash Xtractor II is only part of the drying process. Consult you Omni Pro Restoration distributor for information about training and equipment required for proper water damage restoration.

**A. FRONT TO BACK
EXTRACTION PATTERN**

| | | | |
|---------------|---|---|-----|
| START HERE | → | ↓ | END |
| ↓ | ↑ | ↓ | ↑ |
| ↓ | ↑ | ↓ | ↑ |
| ↓ | ↑ | ↓ | ↑ |
| ↓ | ↑ | ↓ | ↑ |
| ↓ | ↑ | ↓ | ↑ |
| → | ↑ | → | ↑ |

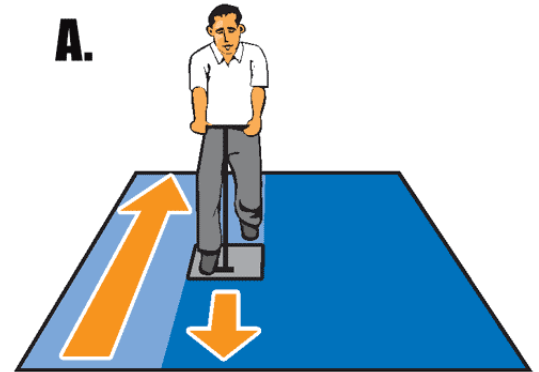

**B. SIDE TO SIDE
EXTRACTION PATTERN**

| | | | |
|---------------|---|---|-----|
| START HERE | → | → | ↓ |
| ↓ | ← | ← | ← |
| → | → | → | ↓ |
| ↓ | ← | ← | ← |
| → | → | → | ↓ |
| ↓ | ← | ← | ← |
| → | → | → | END |

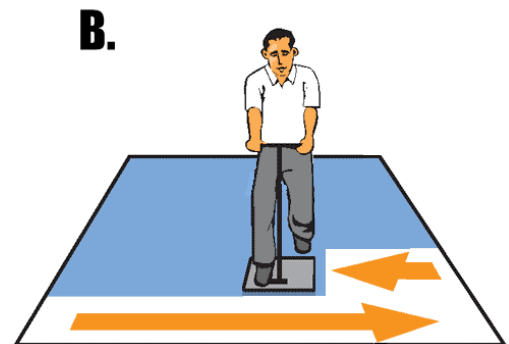

MAINTENANCE

Your Flash Xtractor II requires very little maintenance. To keep your Flash Xtractor II looking and working its best for the longest period of use:

- Rinse the Flash Xtractor II after use, wipe down and let dry.
- Examine the vacuum slot and remove debris as needed.
- Examine the Vacuum Elbow Seal and Base Gasket. Re-seal or replace as needed.



If an excessive amount of debris has been lodged in the slot or is caught inside, the Flash Xtractor II can be disassembled for cleaning.

The Base Plate can be removed from the Top Plate by removing the ten screws and the four 5/16” bolts. Reseal the **Base Plate & Top Plate** with silicone sealant when re-assembling the Flash Xtractor II.

(See parts breakdown on Pages 7-9)

The Vacuum Elbow can be removed from the Top Plate by removing the six screws. Re-seal the **Vacuum Elbow & Top Plate** with silicone sealant as needed.

The Handle Base or Foot Bracket can be removed from the Top Plate by removing the four screws. Replace the **Foot Bracket Gasket NM5523**.

The handle of the Flash Xtractor II can be disconnected from the base for storage by pressing in the spring button and pulling the handle up away from the Handle Base or Foot Bracket. If worn or torn, the **Foam Handle Grips, part NM5512** can be replaced.



HANDLE ASSEMBLY - COMPLETE
NM5522A

HANDLE BASE / FOOT BRACKET
NM5549

VACUUM ELBOW
NM5527

TOP PLATE (Top View)
NM5524

BASE BUMPER
NM5528

SCREW 5/16-18 X 3.5" SBHS SS
NM5545

BASE PLATE (Bottom View)
NM5525

SCREW #14 X 5/8" PFH SS
NM5521

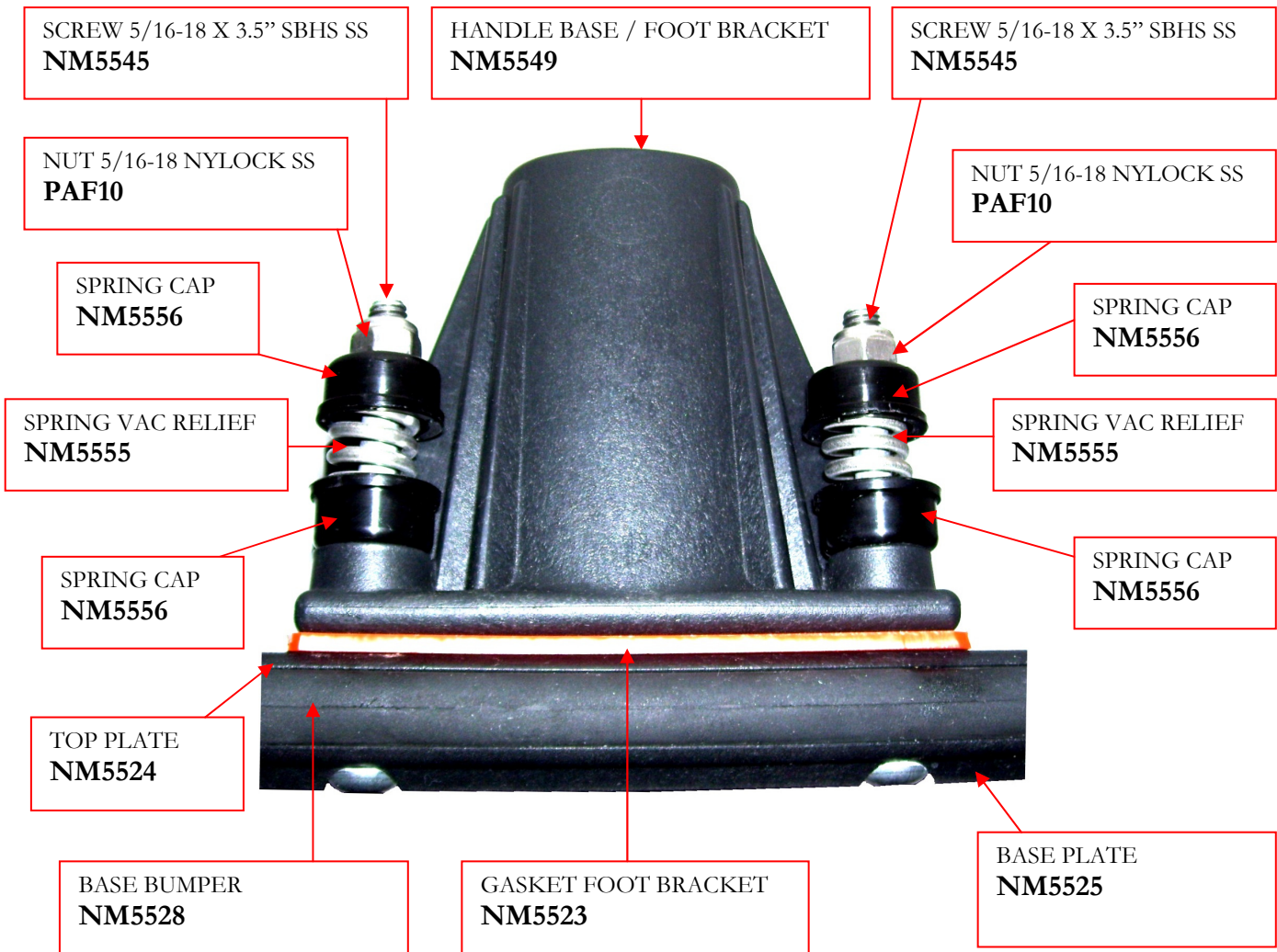

SCREW #14 X 5/8" PFH SS
NM5521

VACUUM ELBOW
NM5527

Silicone sealant used to seal between elbow & top plate

TOP PLATE (Bottom View)
NM5524

Silicone sealant used to seal between top plate & base plate

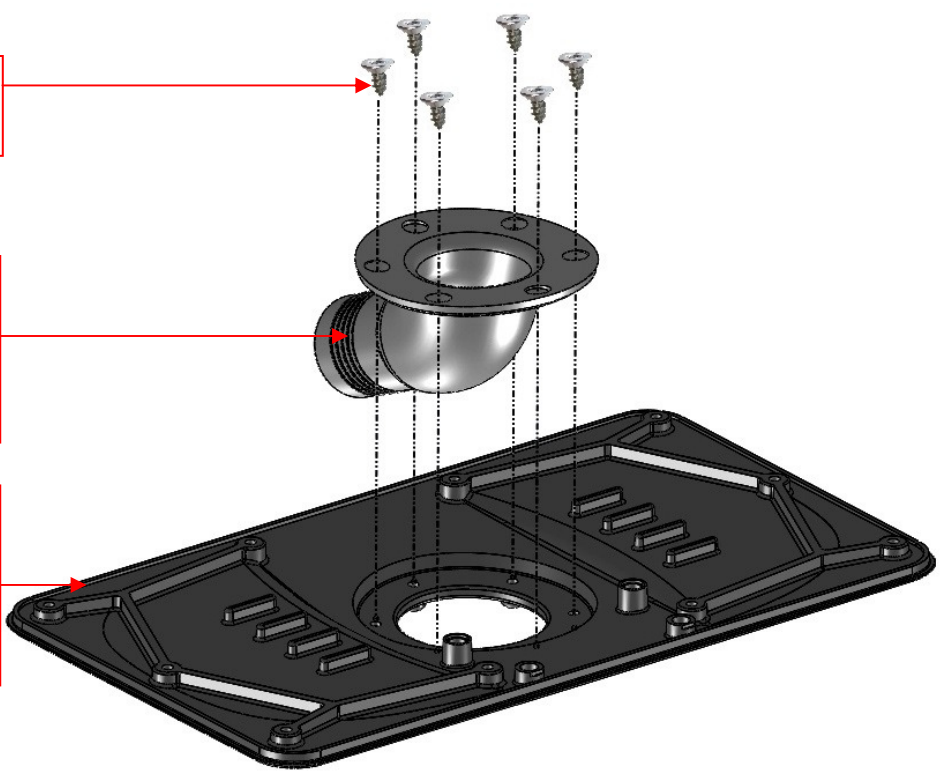

VACUUM ELBOW
NM5527

TOP PLATE (Top View)
NM5524

BASE BUMPER
NM5528

BASE PLATE (Top View)
NM5525

Silicone sealant used to seal between top plate & base plate

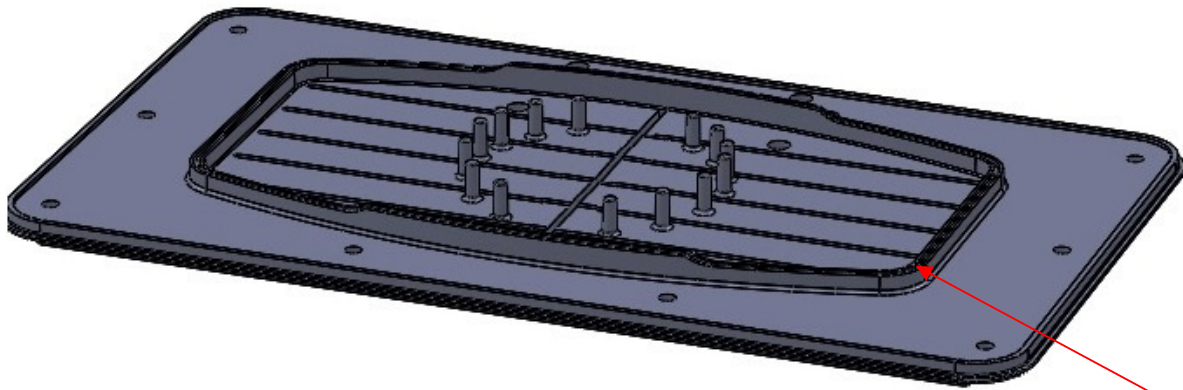
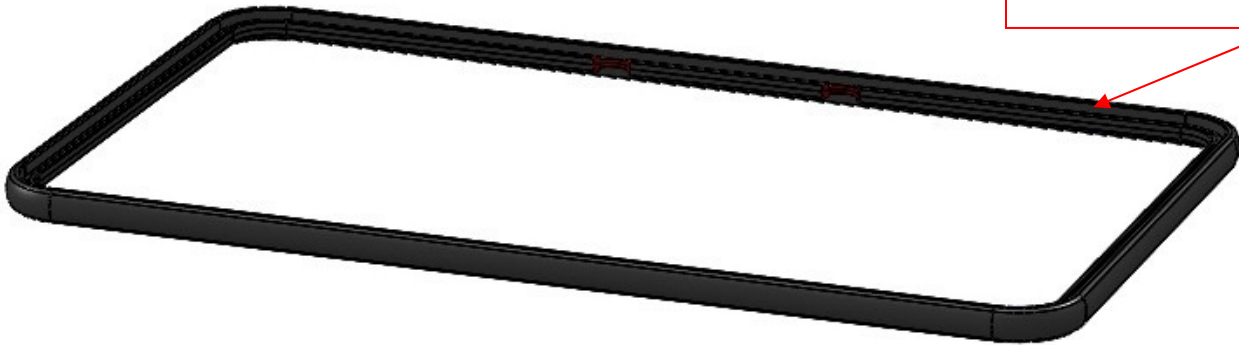
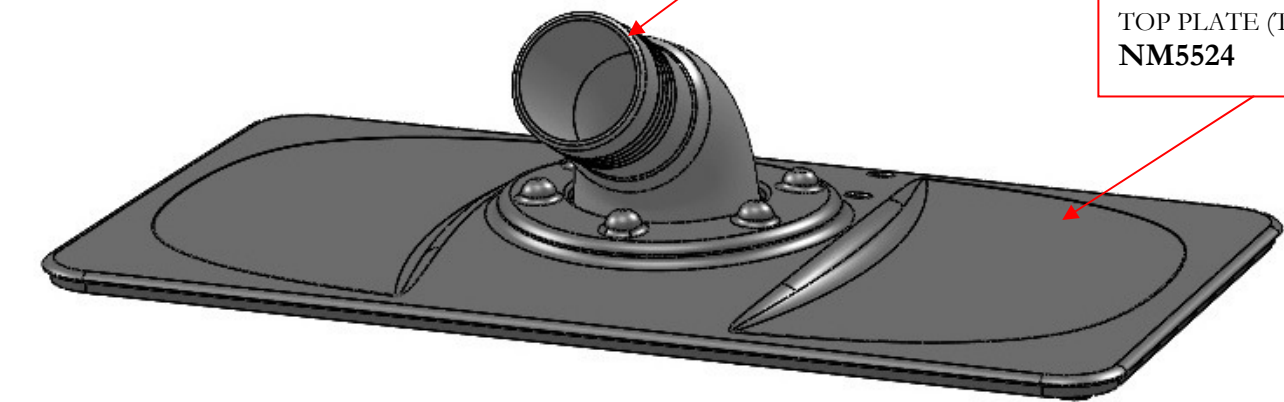

LIMITED WARRANTY

Your Flash Xtractor II is designed to give you years of reliable service. If a problem should arise use the troubleshooting section in the operation manual to diagnose and correct the problem if possible.

If you are unable to determine the cause or solution to the problem contact your distributor or Water Claw for assistance.

Water Claw warrants the Flash Xtractor II to be free from defects in material or workmanship for two years from the date of purchase.

During the warranty period, Water Claw will, at its option repair or replace components which prove to be defective. This warranty does not provide for replacement of complete units due to defective components. Any costs for transportation or related service labor are not covered in this warranty. Replacement parts are warranted only for the remainder of the original warranty period.

This warranty shall not apply to defects resulting from improper operation, lack of maintenance, unauthorized modification, chemical incompatibility, misuse, abuse or exposure to freezing temperature conditions. It does not apply to items which require replacement as a result of ordinary usage.

To obtain warranty service for the Flash Xtractor II, contact your distributor or Water Claw. If the tool must be returned to Water Claw or an authorized service center, the purchaser shall prepay shipping charges for products returned for warranty service. No returned items will be accepted by Water Claw without prior authorization. All returns must have a return authorization number, issued by Water Claw, clearly marked on the exterior of the package.

Water Claw makes no other warranty either expressed or implied with respect to this product.

The remedies provided herein are the purchaser's sole and exclusive remedies. In no event shall Water Claw be liable for any direct, indirect, special, incidental or consequential damages.

This warranty gives you specific legal rights. You may also have other rights which vary from jurisdiction to jurisdiction.